

Please cut where indicated and insert the label into the plastic pocket on the spine of the binder.

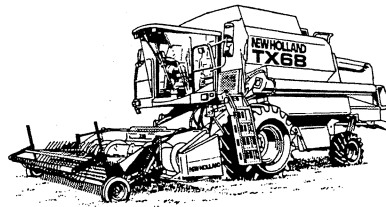

**COMBINE  
REPAIR  
TX66, TX68**

**Vol. 1  
86603389**



**COMBINE  
REPAIR  
TX66, TX68**

**Vol. 1  
86603389**





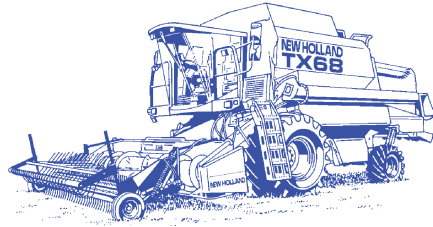

# NEW HOLLAND TX66 TX68

# REPAIR MANUAL

- Section 1 - Introduction
- Section 2 - Traction and Steering Axle
- Section 3 - Grain Header
- Section 5 - Straw Elevator
- Section 6 - Threshing
- Section 7 - Separation
- Section 8 - Cleaning
- Section 9 - Grain Storage
- Section 10 - Straw Chopper/Chaff Spreader



NEW HOLLAND

**SERVICE**

# TX66, TX68 REPAIR MANUAL

## CONTENTS



- SECTION 1 - INTRODUCTION**
- SECTION 2 - TRACTION AND STEERING AXLE**
- SECTION 3 - GRAIN HEADER**
- SECTION 4 - DOES NOT APPLY TO THIS PRODUCT**
- SECTION 5 - STRAW ELEVATOR**
- SECTION 6 - THRESHING**
- SECTION 7 - SEPARATION**
- SECTION 8 - CLEANING**
- SECTION 9 - GRAIN STORAGE**
- SECTION 10 - STRAW CHOPPER/CHAFF SPREADER**
  
- SECTION 11 - DOES NOT APPLY TO THIS PRODUCT**
- SECTION 12 - ENGINES**
- SECTION 13 - AIR CONDITIONING**
- SECTION 14 - HYDRAULIC SYSTEM**
- SECTION 15 - HYDROSTATIC SYSTEM**
- SECTION 16 - ELECTRICAL SYSTEM**

## INTRODUCTION

	<b>Page</b>
Explanation of machine and header serial numbers	3
Notes for Service Parts Catalogue consulting	4
Conversion chart	6
Tightening torques	7
Speed ranges	9
Oil application guide	13



## EXPLANATION OF MACHINE AND HEADER SERIAL NUMBERS

### Machine serial number

#### PRODUCT IDENTIFICATION

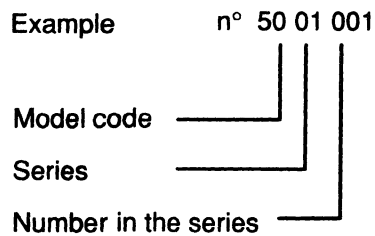

#### Explanation of model code

- Type 48 = TX62
- 49 = TX64
- 66 = TX65
- 50 = TX66
- 51 = TX68

### Header number

#### PRODUCT IDENTIFICATION

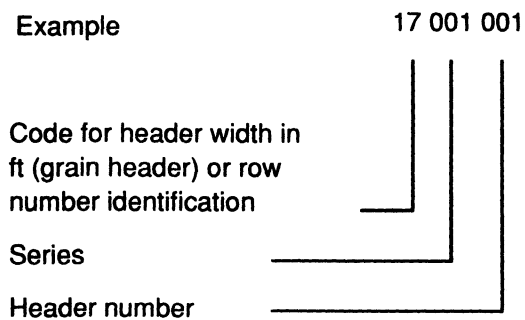

#### AVAILABLE HEADERS

- 12: 12 ft width grain header
- 13: 13 ft width grain header
- 15: 15 ft width grain header
- 17: 17 ft width grain header
- 20: 20 ft width grain header
- 24: 24 ft width grain header
- 56: 5-row maize header
- 57: 7-row maize header

NOTES FOR SERVICE PARTS CATALOGUE CONSULTING

NOTES FOR CATALOGUE CONSULTING

UPDATING ONLY MICROFICHE

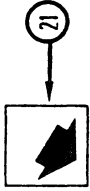
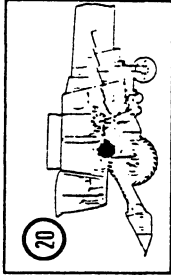

MODIF	ITEM	PART NR	NT Q.	DESCRIPTION	DENOMINAZIONE	DESIGNATION	L.C.
	1	84007894	1	SPACER	DISTANZIALE	ENTRETOISE	0750
	2	80380429	1	GREASE ZERK	INGRASSATORE	GRASSEUR	060
	3	84000265	1	BEARING	CUSCINETTO	ROULEMENT	341C
	4	80100020	4	NUT, M16	DADO	ECROU	0100
	5	80140048	4	LOCKWASHER, 16MM	ROSETTA DI SICUREZZA	RONDELLE DE SECURITE	132R
	6	80120089	4	BOLT, M16 x 40	BULLONE	BOULON	140B
	7	80353308	2	NUT, M6	DADO	ECROU	0100
	8	80140015	2	WASHER, 6MM	ROSETTA PIANA	RONDELLE	131R
	9	84007920	1	CAM (10)	CAMMA	CAME	040C
	10	80062312	A	1 SCREW, M10 x 25	VITE	VIS	040V

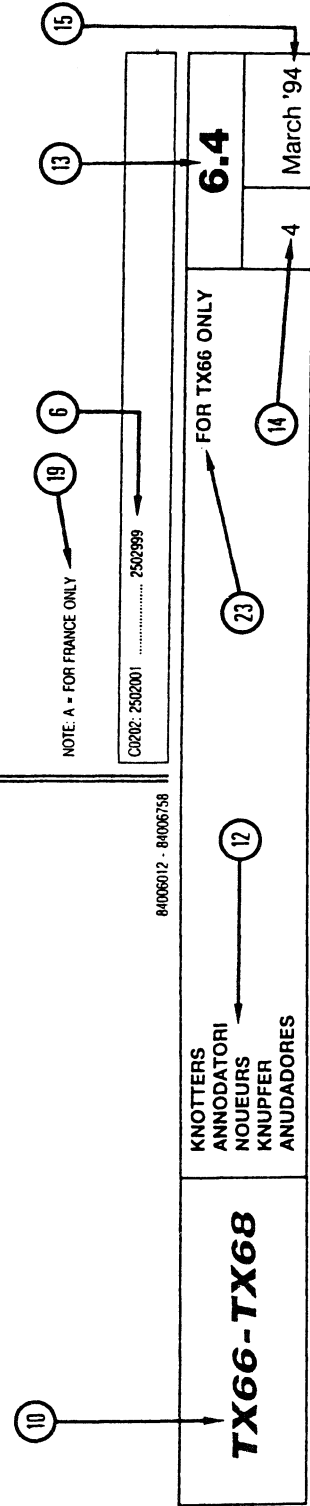
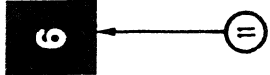
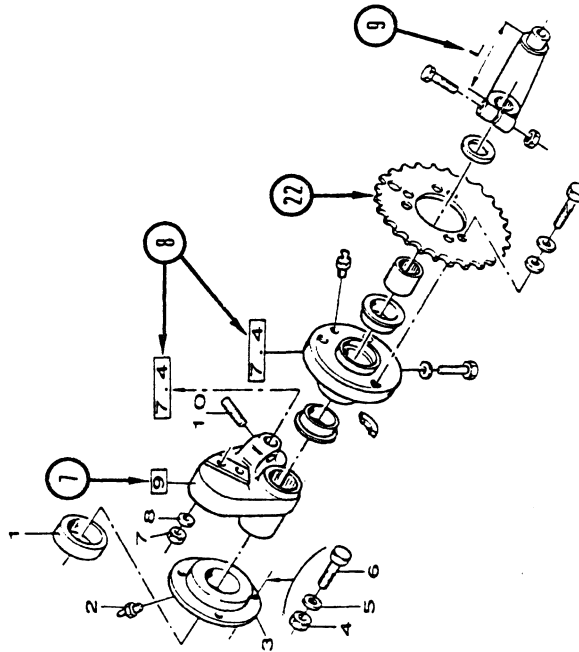

NOTE: A - FOR FRANCE ONLY

C0202: 2502001 ..... 2502999

84006012 - 84006758

KNOTTERS  
ANNODATORI  
NOUEURS  
KNUPFER  
ANUDADORES

**TX66-TX68**

FOR TX66 ONLY

**6.4**

March '94



**ENGLISH**

1	ITEM	-	Reference - Code of Part Number.	9	Technical specifications relating to the Part indicated.
2	PART NR.	-	Part Number.	10	Model Trademark.
3	NT	-	Note - relating to the Part Number. There is a key to symbols and abbreviations at the bottom of the text page.	11	"Section" Code.
4	Q.	-	Total Quantity of the Part referred to in the page. The quantity can be replaced by the following indications: M = supplied in metres. AR = quantity as requested.	12	"Group" name.
5	MODIF.	-	Modification. C 0202 = Part valid UNTIL 0202. D 0300 = Part valid FROM 0300.	13	"Group" code.
6	Implementation of change. Serial number from which the change starts. The numbers are indicated on the identification plate of the model (see page 5). E.g.: D0300 Serial n° 2503001 means that the part has been installed "FROM" serial number 2503001. Consequently, the parts marked by C0202, were installed UP TO serial number 2502999.			14	Page number.
7	<div style="border: 1px solid black; display: inline-block; padding: 2px 10px;">2</div>	-	Includes item(s) ..... (See English description)	15	Date of printing or updating of page (month-year).
8	<div style="border: 1px solid black; display: inline-block; padding: 2px 10px;">1.5</div>	-	Part illustrated in the Group.	16	Part Description.
				17	L.C.-Lexicon code for the identification of Part names in German and Spanish (see page 33).
				18	Further description of the Part. Besides the specific indications of the Part such as size and use, common descriptions can be utilized (see page 34).
				19	Specific Notes to the illustrations or to the text.
				20	Position of the "Section" on the machine.
				21	Running direction (see page 34).
				22	Parts illustrated without item number are shown in the following group.
				23	General information of the group.

## CONVERSION CHART

	Foot	Yard	Mile	Inch	Metre
<b>1 Foot</b>	1	0.333	–	12	0.3048
<b>1 Yard</b>	3	1	–	36	0.9144
<b>1 Mile</b>	5280	1760	1	63360	1609.35
<b>1 Inch</b>	0.0833	0.0277	–	1	0.0254
<b>1 Metre</b>	3.281	1.0936	–	39.37	1

1 US bushel = 35.2391 litre

1 US quart = 0.9464 litre

1 UK bushel = 36.3687 litre

1 UK quart = 1.1365 litre

1 US gallon = 3.785 litre

1 UK gallon = 4.5461 litre

1 barrel = 158.987 litre

1 litre = 0.028 US bushel

1 litre = 1.056 US quart

1 litre = 0.027 UK bushel

1 litre = 0.879 UK quart

1 litre = 0.264 US gallon

1 litre = 0.22 UK gallon

1 litre = 0.0063 barrel

1 acre = 0.4047 ha

1 pound = 0.4536 kg

1 hp = 0.736 kW

1 lb/ in<sup>2</sup> = 0.0689 bar  
= 6.894 kPa

1 pa = 10<sup>-5</sup> bar  
= 1.450x10<sup>-4</sup> lbs/ in<sup>2</sup>

1 kgf.m = 9.806 Nm

1 lbf ft = 0.1385 kgm

1 ha = 2.471 acre

1 kg = 2.204 pound

1 kW = 1.358 hp

1 bar = 14.5 lbs/ in<sup>2</sup>  
1 kPa = 0.145 lbs/ in<sup>2</sup>

1 bar = 100 kPa  
1 lb/ in<sup>2</sup> = 6.896 kPa

1 Nm = 0.1019 kgf.m

1 kgf.m = 7.22 lbf ft

## TIGHTENING TORQUES

### Metric hardware

Nominal size	Property class 5-8 Torque Nm		Property class 8-8 Torque Nm			Property class 10-9 Torque Nm	
	plain	plated	lock nut	plain	plated	plain	plated
M4	1.7	2.2	2.3	2.6	3.4	3.7	4.8
M6	5.8	7.1	7.9	8.9	12	3	17
M8	14	18	19	22	28	31	40
M10	28	36	38	43	56	61	79
M12	49	63	66	75	97	107	138
M16	121	158	164	186	240	266	344
M20	237	307	331	375	485	519	671
M24	411	531	573	648	839	897	1160

**Imperial hardware**

Diameter	SAE GR 2	SAE GR 5		SAE GR 8	
	TORQUE				
	Nm	Nm		Nm	
		A	B	A	B
	1/4"	7	11	10	16
5/16"	14	24	20	35	29
3/8"	24	42	34	65	53
7/16"	42	72	58	102	81
1/2"	61	111	90	156	125
5/8"	111	231	190	319	258
3/4"	210	393	312	563	448
7/8"	224	583	461	814	651
1"	339	868	692	1220	976

A. Bolts not oiled

B. Bolts oiled

Identification

Specification



SAE - Grade 1

No identification

SAE - Grade 2



SAE - Grade 5



SAE - Grade 8

**SPEED RANGES** (maximum idle)

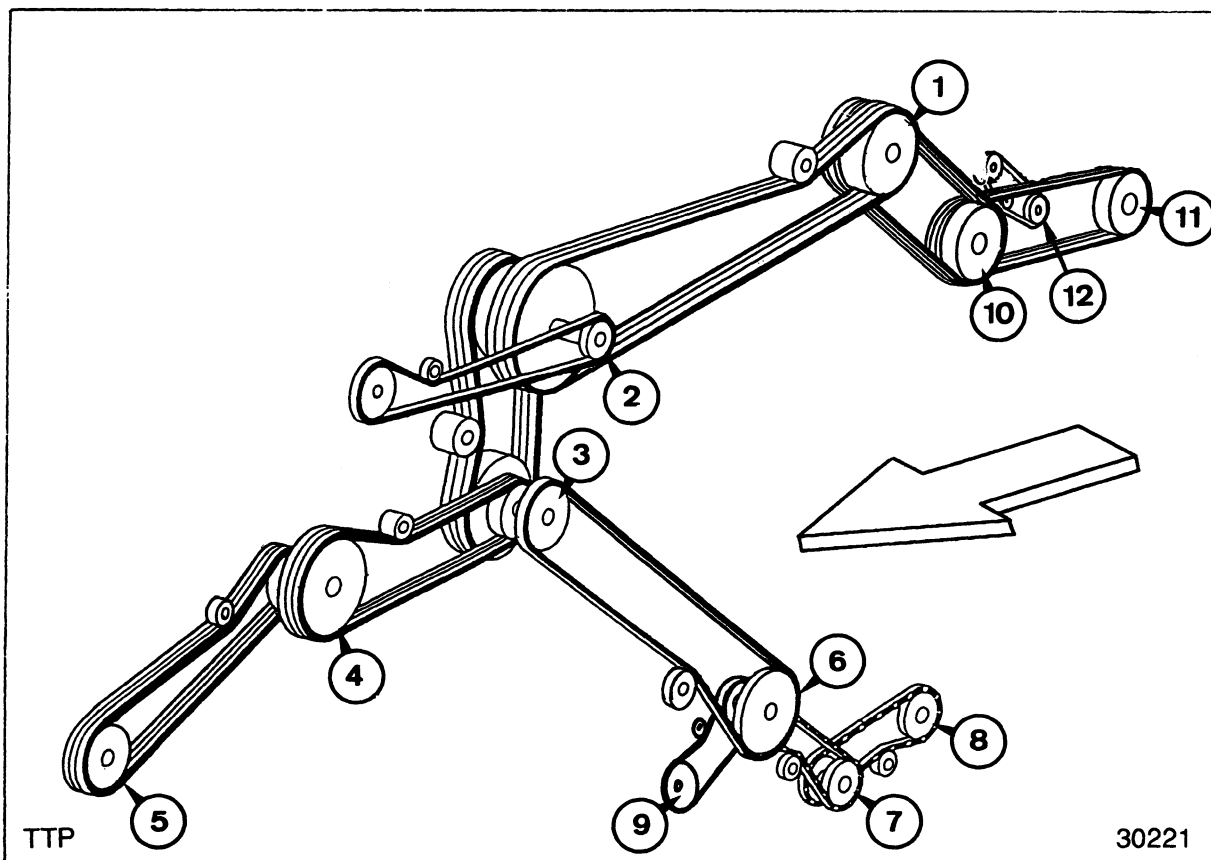

Fig. 1

**Combine left-hand side (Fig. 1)**

	<b>TX62-64-65-66</b>	<b>TX68</b>
	<b>rpm</b>	<b>rpm</b>
1 Engine	2500	2100
2 Loose pulley on beater shaft	1340	1340
3 Intermediate shaft	800	800
4 Straw elevator top shaft	374	374
5 Header drive	433 (575 for Canada and Australia)	
6 Cleaning shoe drive	600 (540*)	600 (540*)
7 Returns cross auger and roto-thresher (TX68-66 only)	800 (720*)	800 (720*)
8 Returns auger and thrower (TX68-66 only)	600 (540*)	600 (540*)
9 Eccentric shaft	320 (288*)	320 (288*)
10 Chopper drive	2098	2098
11 Chopper	3500	3500
12 Chaff spreader (input shaft)	330	330

\* When using small diameter drive pulley 3

Combine right-hand side (Fig. 2)

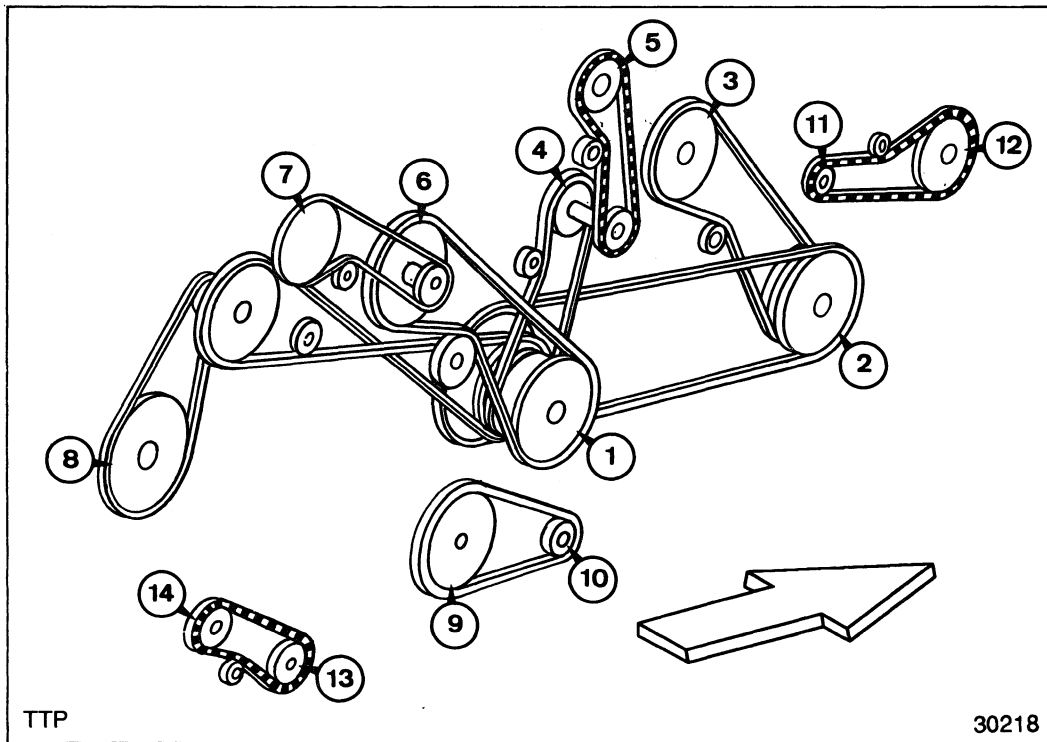

Fig. 2

		rpm	
1	Intermediate shaft	800	
2	Threshing drum	385 to 1140	
3	Beater	256 to 760	
4	Bubble-up auger speed (gearbox)		
	standard:	370	
	option:	441	
5	Grain elevator top shaft		
	standard:	382	
	option:	456	
6	Rotary separator	760 or 400	
7	Straw flow beater	760 or 400	
8	Straw walker	220	
9	Eccentric shaft	320	288*
10	Cleaning fan	500 to 920	450 to 838*
11	Graintank unloading intermediate shaft	1340	
12	Graintank unloading auger	604	
13	Returns cross auger and rotothresher	800	720*
14	Returns auger and thrower	600	540*

\* When using small diameter drive pulley 3 on left-hand side

**Combine engine compartment**

Models TX62-64-65-66: Ford 675 TA (Fig. 3)

	<b>TX62</b>	<b>TX64/65</b>	<b>TX66</b>
	<b>rpm</b>	<b>rpm</b>	<b>rpm</b>
1 Engine	2100	2500	2500
2 Hydraulic pump	2564	2564	2564
3 Alternator	5817	6925	6925
4 Intermediate shaft	2600	2600	1552
5 Airconditioning compressor	2453	2453	2453
6 Rotary screen	300	300	300
7 Engine fan	1567	1866	1475

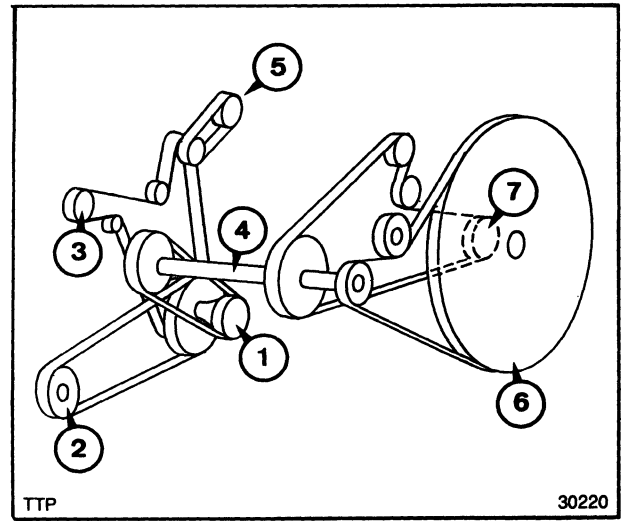

Fig. 3

Model TX68: IVECO 8460SRI (Fig. 4)

	<b>rpm</b>
1 Engine	2100
2 Hydraulic pump	2564
3 Alternator	3934
4 Intermediate shaft	1563
5 Airconditioning compressor	2355
6 Rotary screen	302
7 Engine fan	1475

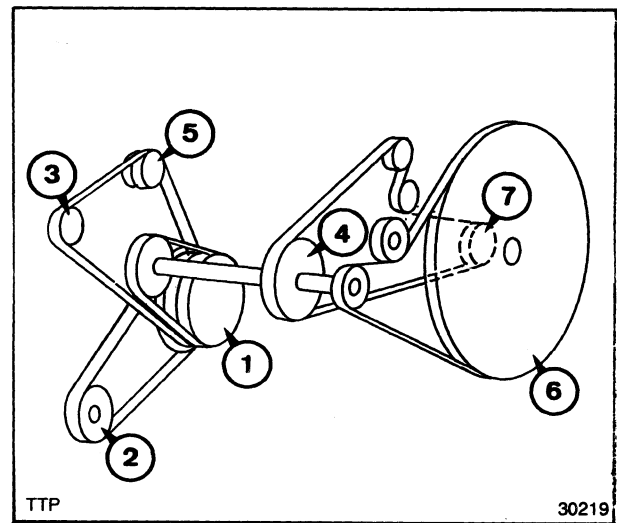

Fig. 4

**Grain header (Fig. 5)**

- |   |  |                              |
|---|--|------------------------------|
| 1 | Knife speed  | 575 rpm (1150 cuts/min)      |
| 2 | Reel speed with<br>23-tooth sprocket<br>13-tooth sprocket  | 21 to 57 rpm<br>12 to 32 rpm |
| 3 | Auger speed with<br>44-tooth sprocket<br>52-tooth sprocket | 176 rpm<br>150 rpm           |

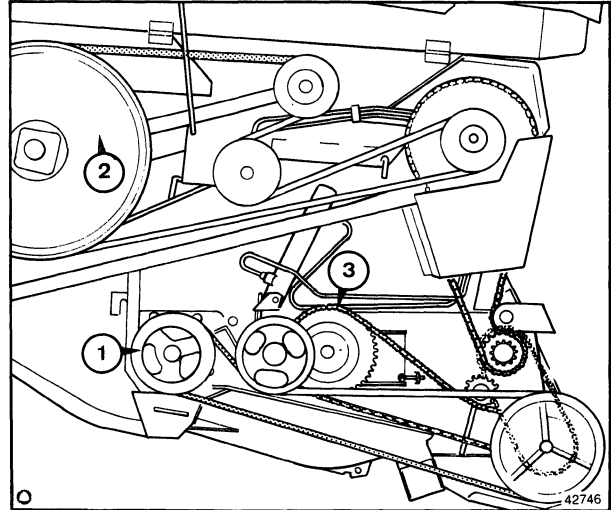

Fig. 5

**Maize header (Fig. 6)**

- |   |  |  |
|---|--|--|
| 1 | Auger speed  | 144 rpm                                |
| 2 | Stalk roll speed with<br>28-tooth sprocket<br>24-tooth sprocket<br>20-tooth sprocket | 892 rpm<br>1041 rpm<br>1249 rpm        |
| 3 | Gathering chains with<br>28-tooth sprocket<br>24-tooth sprocket<br>20-tooth sprocket | 1.27 m/sec<br>1.47 m/sec<br>1.76 m/sec |

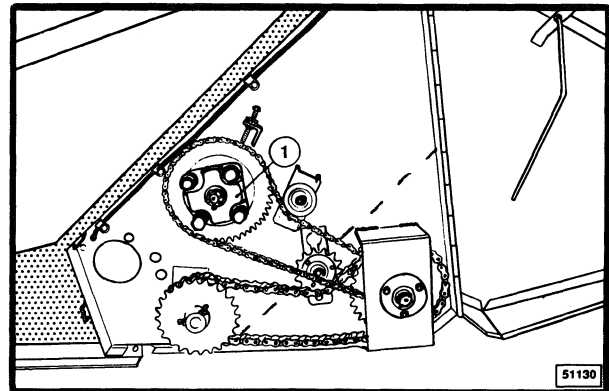

Fig. 6



## OIL APPLICATION GUIDE

<b>Lubricant</b>	<b>Recommended FNH product</b>	<b>Corresponding international classification</b>
Engine oil	M2C-121-C (SAE 15W-40)	API CE/SF CCMC D4/G2 MIL-L-2104 D
Gearbox oil	M2C-94-A (SAE 80W-90)	API GL-5 MIL-L-2105 D
Hydraulic oil Hydrostatic oil	M2C-48-C3	ISO HV 46 DIN 51524 H-LP32 H-LP46
Chains Threaded rods Pivot points	M2C-94-A	SAE 90 gear oil
Grease nipples	M1C-137A	NLGI - class 2
Brake fluid	M6C-25-A	SAE J 1703A DOT 4
Tracks	M2C-159-B	API-CC-CD MIL-L-2104 C
Airconditioning compressor	—	—
Antifreeze	E 2218 - T - 9	BSS 6580



## TRACTION AND STEERING AXLE

	<b>Page</b>
Models TX62-64-65-66-68	1 to 44
Model TX67	45 to 54



**Thanks very much for your reading,  
Want to get more information,  
Please click here, Then get the complete  
manual**

**JustClickHere** 

**NOTE:**

**If there is no response to click on the link above,  
please download the PDF document first, and then  
click on it.**

**Have any questions please write to me:  
[admin@servicemanualperfect.com](mailto:admin@servicemanualperfect.com)**